

# 10A/16A铜质插座 10A/16A MARINE BRASS JUNCTION SOCKER

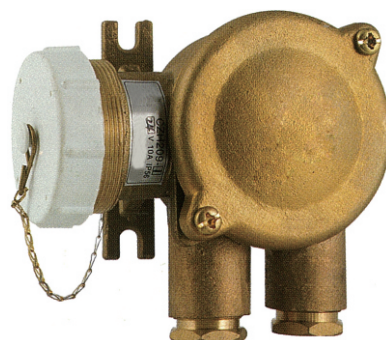

防护等级: IP56  
 电缆外径:  $\phi 14-\phi 16$   
 Protection class: IP56  
 Cable outside Diameter:  $\phi 14-\phi 16$

电气  
接插件  
Electric Connectors

## 技术特性:

1. 供舰船交直流低电压电器线路连接、接通与分断电路用;
2. 插头单极拔出应为  $\geq 4N$ ;
3. 导电部分的温升不超过40K;
4. 金属外表有可靠接地装置;
5. 盖板螺丝为M6防松螺钉。

## 产品认证

1. 通过欧共体CE认证;
2. 通过中国船级社"CCS"认证。

## 采用标准

DIN89262

## Technical characteristic

1. Used for connecting cutting on or off the appliance circuit with AC or DC low-voltage.
2. The single pole of plug pulled out should be not less than 4N.
3. The temperature rise of conductive part should don't exceed 40K.
4. The metal shell should have reliable earthing device.
5. The screw of cover plate is M6 locking screw.

## Production authentication

1. Approved by CE.
2. Approved by CCS(China Classification Society).

## Adopt standard

DIN89262

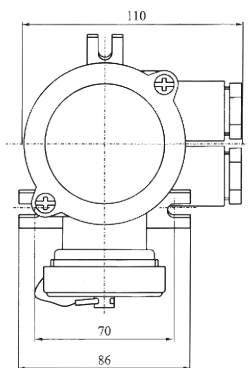
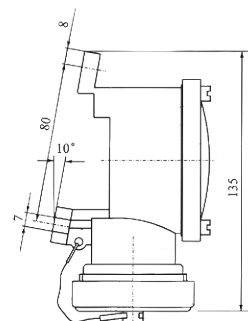

	电压Voltage	24V	125V	250V	500V	500V
	插销示意图Plug pin diagram					
-O	代号Code	1141				
	一般电缆型号General cable type	CZH101-1	CZH101-2	CZH101-3	CZH101-4	CZH101-5
	屏蔽电缆型号Shield cable type	CZH111-1	CZH111-2	CZH111-3	CZH111-4	CZH111-5
	重量Weight	1.30kg	1.40kg	1.40kg	1.50kg	1.50kg
O-	代号Code	1141/R				
	一般电缆型号General cable type	CZH109-1	CZH109-2	CZH109-3	CZH109-4	CZH109-5
	屏蔽电缆型号Shield cable type	CZH119-1	CZH119-2	CZH119-3	CZH119-4	CZH119-5
	重量Weight	1.30kg	1.40kg	1.40kg	1.50kg	1.50kg
-O-	代号Code	1141/D				
	一般电缆型号General cable type	CZH201-1	CZH201-2	CZH201-3	CZH201-4	CZH201-5
	屏蔽电缆型号Shield cable type	CZH211-1	CZH211-2	CZH211-3	CZH211-4	CZH211-5
	重量Weight	1.40kg	1.50kg	1.50kg	1.50kg	1.60kg
=O	代号Code	1141/2				
	一般电缆型号General cable type	CZH202-1	CZH202-2	CZH202-3	CZH202-4	CZH202-5
	屏蔽电缆型号Shield cable type	CZH212-1	CZH212-2	CZH212-3	CZH212-4	CZH212-5
	重量Weight	1.40kg	1.50kg	1.50kg	1.50kg	1.60kg
O=	代号Code	1141/2/R				
	一般电缆型号General cable type	CZH209-1	CZH209-2	CZH209-3	CZH209-4	CZH209-5
	屏蔽电缆型号Shield cable type	CZH219-1	CZH219-2	CZH219-3	CZH219-4	CZH219-5
	重量Weight	1.40kg	1.50kg	1.50kg	1.50kg	1.60kg