

10A船用尼龙开关  
10A MARINE NYLON SWITCH

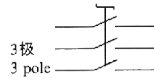

防护等级: IP56  
 电缆外径:  $\phi 14 - \phi 16$   
 Protection class: IP56  
 Cable outside Diameter:  $\phi 14 - \phi 16$

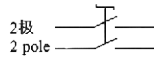

接线示意图 wiring sketch map

**技术特性:**

1. 供舰船交直流低电压电器线路连接、接通与分断电路用;
2. 导电部分的温升不超过40K;
3. 盖板螺丝为M6防松螺钉。

**产品认证**

1. 通过欧共体CE认证;
2. 通过中国船级社"CCS"认证。

**采用标准**

DIN89270

**Technical chracteristic**

1. Used for connecting cutting on or off the appliancate circuit with AC or DC low-voltage.
2. The temperature rise of conductive part should don't exceed 40K.
3. The screw of cover plate is M6 locking screw.

**Production authentication**

1. Approved by CE.
2. Approved by CCS(China Classification Society).

**Adopt standard**

DIN89270

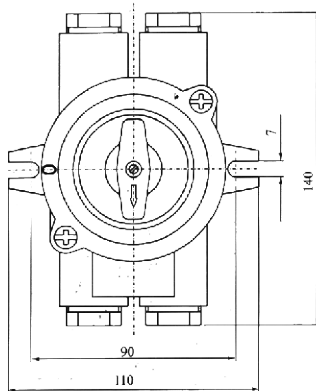
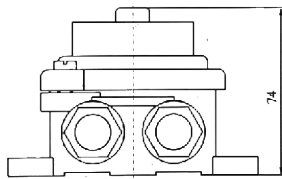

	电压 Voltage	24V	150V	250V	380V/440V	380V/440V
O	代号 Code	1133/FS				
	型号 Type	HS101-1	HS101-2	HS101-3	HS101-4	HS101-5
	重量 Weight	0.22kg	0.22kg	0.22kg	0.22kg	0.22kg
O	代号 Code	1133/D/FS				
	型号 Type	HS201-1	HS201-2	HS201-3	HS201-4	HS201-5
	重量 Weight	0.23kg	0.23kg	0.23kg	0.23kg	0.23kg
O=	代号 Code	1133/2/FS				
	型号 Type	HS202-1	HS202-2	HS202-3	HS202-4	HS202-5
	重量 Weight	0.23kg	0.23kg	0.23kg	0.23kg	0.23kg
-O=	代号 Code	1133/3/FS				
	型号 Type	HS302-1	HS302-2	HS302-3	HS302-4	HS302-5
	重量 Weight	0.24kg	0.24kg	0.24kg	0.24kg	0.24kg
=O=	代号 Code	1133/2D/FS				
	型号 Type	HS402-1	HS402-2	HS402-3	HS402-4	HS402-5
	重量 Weight	0.25kg	0.25kg	0.25kg	0.25kg	0.25kg